

IHLE FABRICATIONS LLC[®]

INSTALLATION INSTRUCTIONS

4 PIECE SUMP KIT LINER

CASE IH[®] LEGACY 1400-2500 SERIES

P/N: IF1145171K (73399582R)

All **Ihle Fabrications** products are made in the USA using the best materials to provide quality auger liner replacement parts. **Ihle Fabrications** a family-owned agriculture and fabrication business and stands behind our craftsmanship.

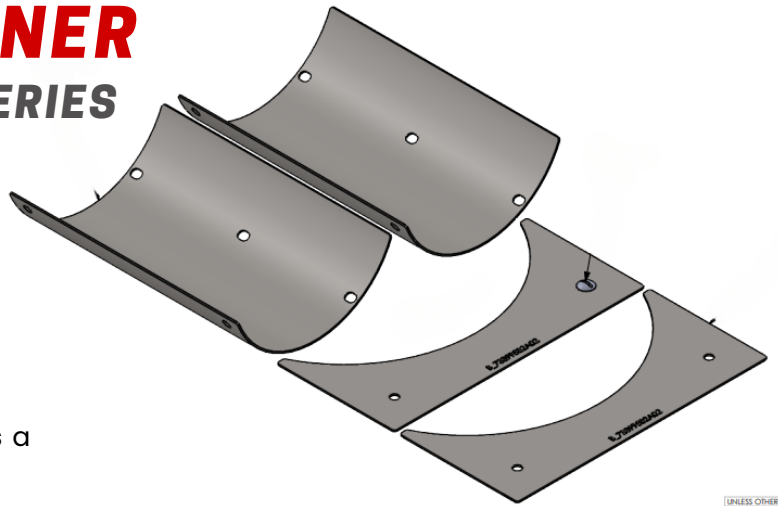

UNLESS OTHERWISE



TOOLS NEEDED

Drill
3/16 Drill Bit
Locking C-Clamps
Rivet Gun
Silicone/Sealer

ITEMS INCLUDED

4 Liner Pieces
14 Slotted Truss Head Bolts
14 Wiz Nuts

THANK YOU FOR YOUR BUSINESS

WWW.IHLEFABRICATIONS.COM

PH: 515-329-8050

4780 NW 158TH AVE.
POLK CITY, IA 50226

INSTALLATION INSTRUCTIONS

4 PIECE SUMP KIT LINER

Step 1: Remove the 6 carriage bolts from the inside of the bottom sump.

Step 2: Insert pieces 1 & 2. Line up pre-punched holes w/ the holes from the carriage bolts.

Step 3: Using new carriage bolts provided, fasten #1 & 2 in place. Do NOT fully tighten bolts until pieces 3 & 4 are installed.

Step 4: Using the 2 pre-punched holes at the top (or bottom) of pieces 1 & 2, drill 2 holes (5/16") through the sump. Fasten carriage bolts to secure liner in place.

Step 5: Insert #3 & 4. Line up to the inner circle of sump. Clamp in place.

Step 6: Using 5/16th drill bit, drill 2 holes through the pre-punched holes into the sump. Secure liner with carriage bolts provided. Fully tighten bolts.

Step 7: Fully tighten bolts in #1 & 2.

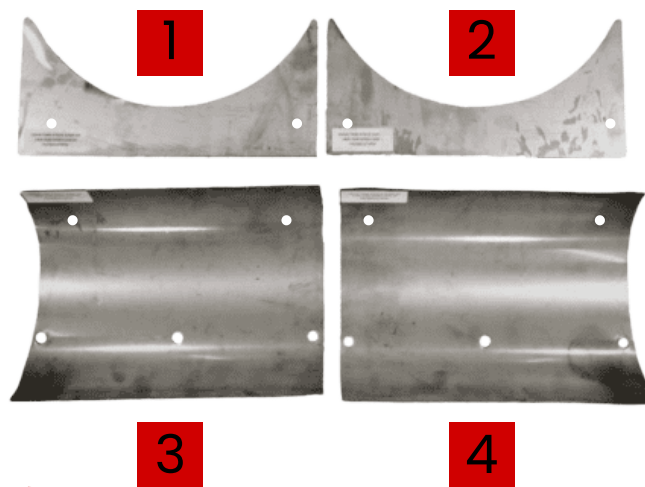

QUESTIONS?

REACH OUT TO OUR TEAM