

IHLE FABRICATIONS LLC[®]

INSTALLATION INSTRUCTIONS

CHAIN TENSIONER UPGRADE KIT

CASE IH[®] FLAGSHIP SERIES

P/N: 84155550R

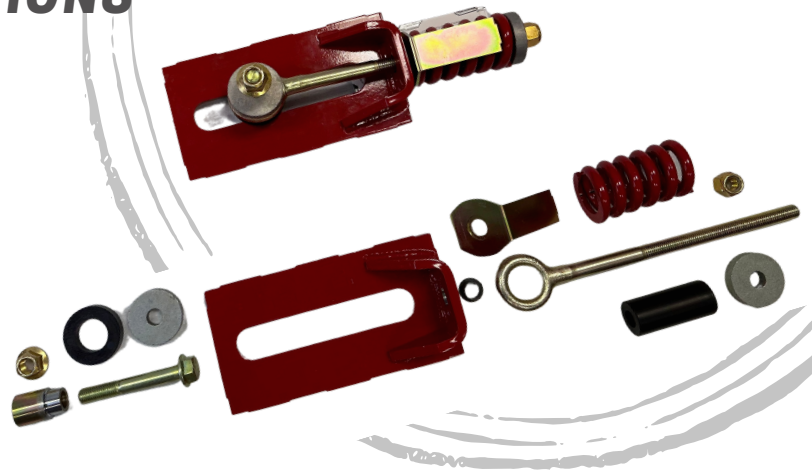

All **Ihle Fabrications** products are made in the USA using the best materials to provide quality auger liner replacement parts. **Ihle Fabrications** a family-owned agriculture and fabrication business and stands behind our craftsmanship.

CAUTION

**WEAR
YOUR
GLOVES**



HARDOX[®]
WEAR PLATE

Hardox[®] Wear Plate is the world's leading abrasion-resistant (AR) steel. Enjoy the benefits of guaranteed toughness in our products made with Hardox[®] Wear Plate.

CAUTION

**WEAR
SAFETY GLASSES
WHEN USING
EQUIPMENT**



TOOLS NEEDED

Welder
Cut off Wheel
Flap Wheel
24mm or 15/16" Wrench
24 mm or 15/16" Deep Well Socket
24 mm or 15/16" Double Deep Socket
Aerosol Spray Paint Case IH Red
Pry Bar
Hammer
Welding Magnets

ITEMS INCLUDED

2 Complete Chain Tensioner Upgrade kits 1 for each side of machine.
Hardware listed on Page 3.

THANK YOU FOR YOUR BUSINESS

WWW.IHLEFABRICATIONS.COM

PH: 515-329-8050

4780 NW 158TH AVE.
POLK CITY, IA 50226

INSTALLATION INSTRUCTIONS

CHAIN TENSIONER UPGRADE KIT

Step 1: Set the Feeder House to a good working height. Set Feeder House safety latch.

Step 2: Unhook and move all electrical and hydraulic lines in close proximity or obstructing the view from the Bracket.

Step 3: Make note of the amount of tension on the chain. Chain Tension can be determined by the amount of droop in the chain and/or the position of the spring indicator compared to the spring.

Step 4: Undo and remove all chain tensioning hardware. Release tension off the chain.

Step 5: Use cut off wheel to remove the welds attaching the tensioning plate to the Feeder House. **(Be careful that you do not cut too deep to avoid creating a hole.)**

Step 6: Use a prybar to remove the old bracket.

Step 7: Use a grinding disk to remove left over welds, rust, or debris from behind the bracket.

Step 8: Use the grinding disk to remove the paint from the weld spots on the new bracket (the indents along the edges).

Step 9: Disconnect the battery and apply grounding clamp to the face of the Feeder House.

Step 10: Position the new bracket where the old was. Use welding magnets to line the bracket and the Feeder House slot exactly.

Step 11: Ensure the bracket is tight to the feeder house - tack weld around. (at this point on the first side you can loosely assemble the hardware to ensure it fits before fully welding)

Step 12: When the bracket is correctly lined up and tack welded in place, fully stitch weld around in the recesses to secure it to the combine.

Step 13: Remove any weld spatter.

Step 14: Repaint using Case IH Red spray can.

Step 15: Assemble hardware as it was before (Also shown on the following page).

Step 16: Repeat this process for both sides.

Step 17: Retension the feeder chain to previous tension.

QUESTIONS?

REACH OUT TO OUR TEAM

4 3

BOM TABLE FOR 84155550R

ITEM NO.	PART NO.	QTY.	DESCRIPTION
1	84155550A03	2	COMPLETE CHAIN TENSIONER UPGRADE KIT (W/DMNT)
2	CNH-47936314	2	SPRING
3	CNH-86558960	2	BUSHING HAT
4	CNH-48154924	2	SPRING_INDICATOR
5	CNH-51431190	2	EYEBOLT TENSION
6	CNH-913347	4	WASHER M17 X 56mm OD X 11mm THK
7	CNH-412066	2	LOCK NUT M16 X 2.0 CL 8
8	CNH-47853303	2	BUSHING
9	CNH-51426442	2	WASHER
10	CNH-87015923	2	FLANGE BOLT M16 X 125.4mm CL 10.9
11	CNH-87016581	2	FLANGE NUT M16 X 2.0 CL 10
12	CNH-51687031	2	SPACER

2 1

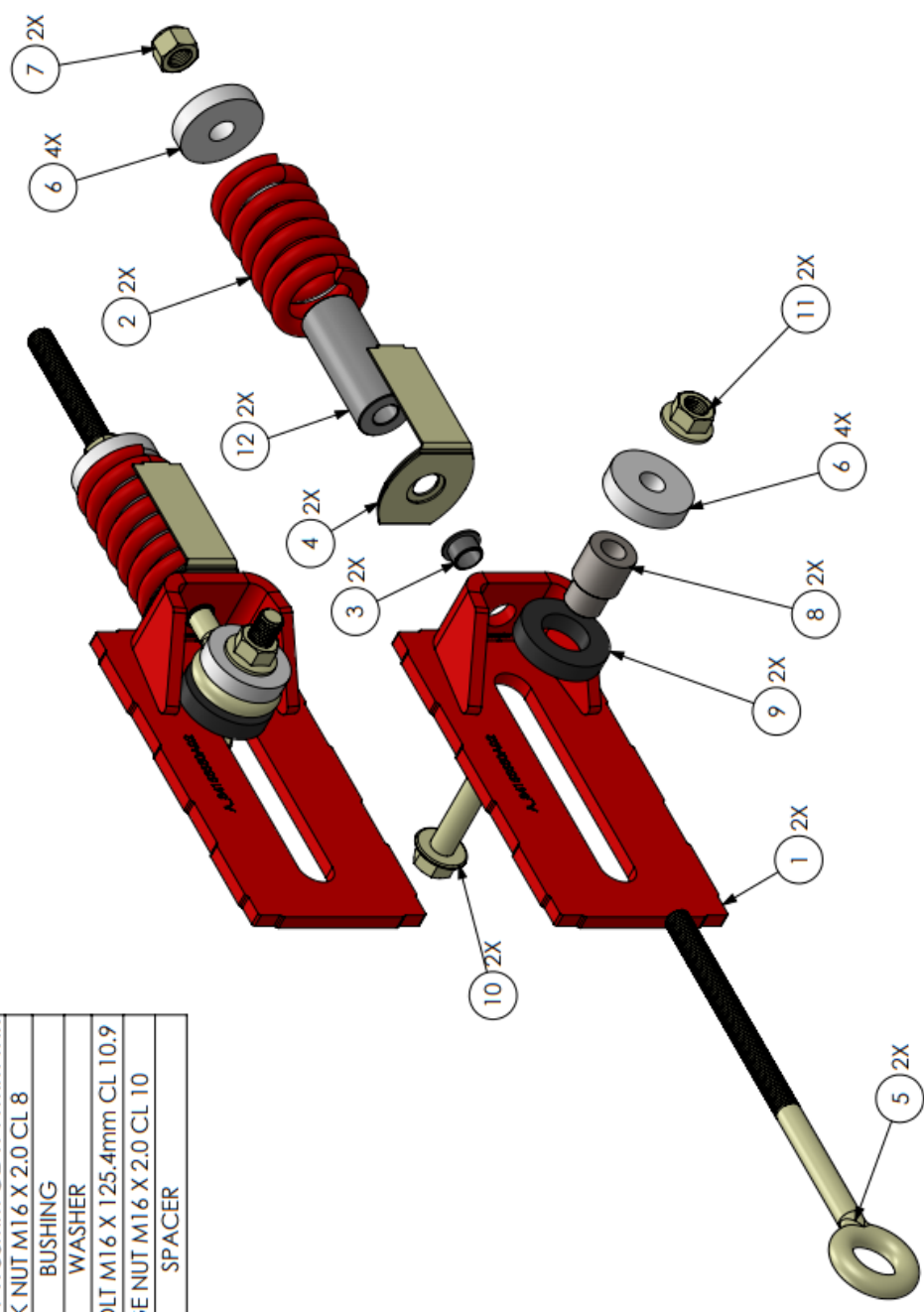

B

A

4

3

2

1